

PINA®

Your Swiss Option

PLINTUS_{Titan}



| Art.-No. | 0 Degrees | Length | Width | Height |
|------------|-----------|--------|-------|--------|
| LC 20.08.0 | | 20 mm | 10 mm | 8 mm |
| LC 20.10.0 | | 20 mm | 10 mm | 10 mm |
| LC 20.12.0 | | 20 mm | 10 mm | 12 mm |
| LC 20.14.0 | | 20 mm | 10 mm | 14 mm |

| Art.-No. | 4 Degrees | Length | Width | Height |
|------------|-----------|--------|-------|--------|
| LC 20.08.4 | | 20 mm | 10 mm | 8 mm |
| LC 20.10.4 | | 20 mm | 10 mm | 10 mm |
| LC 20.12.4 | | 20 mm | 10 mm | 12 mm |
| LC 20.14.4 | | 20 mm | 10 mm | 14 mm |

| Art.-No. | 0 Degrees | Length | Width | Height |
|------------|-----------|--------|-------|--------|
| LC 25.08.0 | | 25 mm | 11 mm | 8 mm |
| LC 25.10.0 | | 25 mm | 11 mm | 10 mm |
| LC 25.12.0 | | 25 mm | 11 mm | 12 mm |
| LC 25.14.0 | | 25 mm | 11 mm | 14 mm |

| Art.-No. | 4 Degrees | Length | Width | Height |
|------------|-----------|--------|-------|--------|
| LC 25.08.4 | | 25 mm | 11 mm | 8 mm |
| LC 25.10.4 | | 25 mm | 11 mm | 10 mm |
| LC 25.12.4 | | 25 mm | 11 mm | 12 mm |
| LC 25.14.4 | | 25 mm | 11 mm | 14 mm |

| Art.-No. | 8 Degrees | Length | Width | Height |
|------------|-----------|--------|-------|--------|
| LC 25.08.8 | | 25 mm | 11 mm | 8 mm |
| LC 25.10.8 | | 25 mm | 11 mm | 10 mm |
| LC 25.12.8 | | 25 mm | 11 mm | 12 mm |
| LC 25.14.8 | | 25 mm | 11 mm | 14 mm |

steril

| Art.-No. | 0 Degrees | Length | Width | Height |
|--------------|-----------|--------|-------|--------|
| LC 20.08.0.S | | 20 mm | 10 mm | 8 mm |
| LC 20.10.0.S | | 20 mm | 10 mm | 10 mm |
| LC 20.12.0.S | | 20 mm | 10 mm | 12 mm |
| LC 20.14.0.S | | 20 mm | 10 mm | 14 mm |

| Art.-No. | 4 Degrees | Length | Width | Height |
|--------------|-----------|--------|-------|--------|
| LC 20.08.4.S | | 20 mm | 10 mm | 8 mm |
| LC 20.10.4.S | | 20 mm | 10 mm | 10 mm |
| LC 20.12.4.S | | 20 mm | 10 mm | 12 mm |
| LC 20.14.4.S | | 20 mm | 10 mm | 14 mm |

| Art.-No. | 0 Degrees | Length | Width | Height |
|--------------|-----------|--------|-------|--------|
| LC 25.08.0.S | | 25 mm | 11 mm | 8 mm |
| LC 25.10.0.S | | 25 mm | 11 mm | 10 mm |
| LC 25.12.0.S | | 25 mm | 11 mm | 12 mm |
| LC 25.14.0.S | | 25 mm | 11 mm | 14 mm |

| Art.-No. | 4 Degrees | Length | Width | Height |
|--------------|-----------|--------|-------|--------|
| LC 25.08.4.S | | 25 mm | 11 mm | 8 mm |
| LC 25.10.4.S | | 25 mm | 11 mm | 10 mm |
| LC 25.12.4.S | | 25 mm | 11 mm | 12 mm |
| LC 25.14.4.S | | 25 mm | 11 mm | 14 mm |

| Art.-No. | 8 Degrees | Length | Width | Height |
|--------------|-----------|--------|-------|--------|
| LC 25.08.8.S | | 25 mm | 11 mm | 8 mm |
| LC 25.10.8.S | | 25 mm | 11 mm | 10 mm |
| LC 25.12.8.S | | 25 mm | 11 mm | 12 mm |
| LC 25.14.8.S | | 25 mm | 11 mm | 14 mm |

Description

The PINA Titanium PLIF-Cage PLINTUS^{Titan} has been developed for the posterior fusion of lumbar vertebrae following decompression and discectomy to secure the vertebral spine, restore the intervertebral gap and secure the lumbar lordosis. The broad, toothed surface profile offers good contact with the vertebral cover plates whose integrity is to be maintained. Different angles of incidence have been designed, flat parallel, 4 degrees and 8 degrees, for an individual securing of the lumbar lordosis.

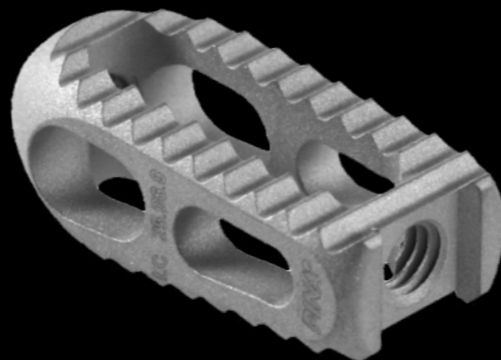

Product characteristic

PLINTUS^{Titan} cages are made from the titanium alloy ISO 5832-3. A large contact surface allows the greatest possible bone contact and reduces the risk of subsidence. Through the existing openings, a filling with autologous bone or bone substitute material is possible. PLINTUS^{Titan} is available in 2 sizes and 3 different angles and 4 heights.

Indications

- Degenerative disc diseases and instabilities
- Degenerative Spondylolisthesis
- Revision surgery

Changes reserved

| 0 Degrees | Length | Width | Height |
|-----------|--------|-------|--------|
| | 20 mm | 10 mm | 8 mm |
| | 20 mm | 10 mm | 10 mm |
| | 20 mm | 10 mm | 12 mm |
| | 20 mm | 10 mm | 14 mm |

| 0 Degrees | Length | Width | Height |
|-----------|--------|-------|--------|
| | 25 mm | 11 mm | 8 mm |
| | 25 mm | 11 mm | 10 mm |
| | 25 mm | 11 mm | 12 mm |
| | 25 mm | 11 mm | 14 mm |

| 4 Degrees | Length | Width | Height |
|-----------|--------|-------|--------|
| | 20 mm | 10 mm | 8 mm |
| | 20 mm | 10 mm | 10 mm |
| | 20 mm | 10 mm | 12 mm |
| | 20 mm | 10 mm | 14 mm |

| 4 Degrees | Length | Width | Height |
|-----------|--------|-------|--------|
| | 25 mm | 11 mm | 8 mm |
| | 25 mm | 11 mm | 10 mm |
| | 25 mm | 11 mm | 12 mm |
| | 25 mm | 11 mm | 14 mm |

| 8 Degrees | Length | Width | Height |
|-----------|--------|-------|--------|
| | 25 mm | 11 mm | 8 mm |
| | 25 mm | 11 mm | 10 mm |
| | 25 mm | 11 mm | 12 mm |
| | 25 mm | 11 mm | 14 mm |

Instruments PLINTUS^{Titan}

